

INLET:
 FX=37.5 LBF [167 N] MY=62.5 LB FT [84.7 N·m]
 FY=37.5 LBF [167 N] MZ=62.5 LB FT [84.7 N·m]
 FZ=37.5 LBF [167 N]

OUTLET:
 MX=46.9 LB FT [63.6 N·m]
 MY=46.9 LB FT [63.6 N·m]
 MZ=46.9 LB FT [63.6 N·m]
 FX=28.1 LBF [125 N] MY=46.9 LB FT [63.6 N·m]
 FY=28.1 LBF [125 N] MZ=46.9 LB FT [63.6 N·m]
 FZ=28.1 LBF [125 N]

FORCE AND MOMENT VALUES ARE RELATIVE TO CENTER OF INLET AND OUTLET PORT FACES.

REVISION HISTORY					
CHG NO	ZONE	REV	DESCRIPTION	DATE	BY / APPROVED

ITEM	DESCRIPTION	APPROXIMATE WEIGHT		MATERIAL
		LBS	KILOGRAMS	
1	MOTOR *(182TC & 184TC)	125.0	56.7	
2	PUMP	18.0	8.2	
3	COUPLING, LOVEJOY L-100	3.5	1.6	
4	BRACKET	5.0	2.3	ALUMINUM
TOTAL		151.5	68.8	

* DRIVER DIMENSIONS MAY VARY WITH TYPE AND MAKE OF DRIVER

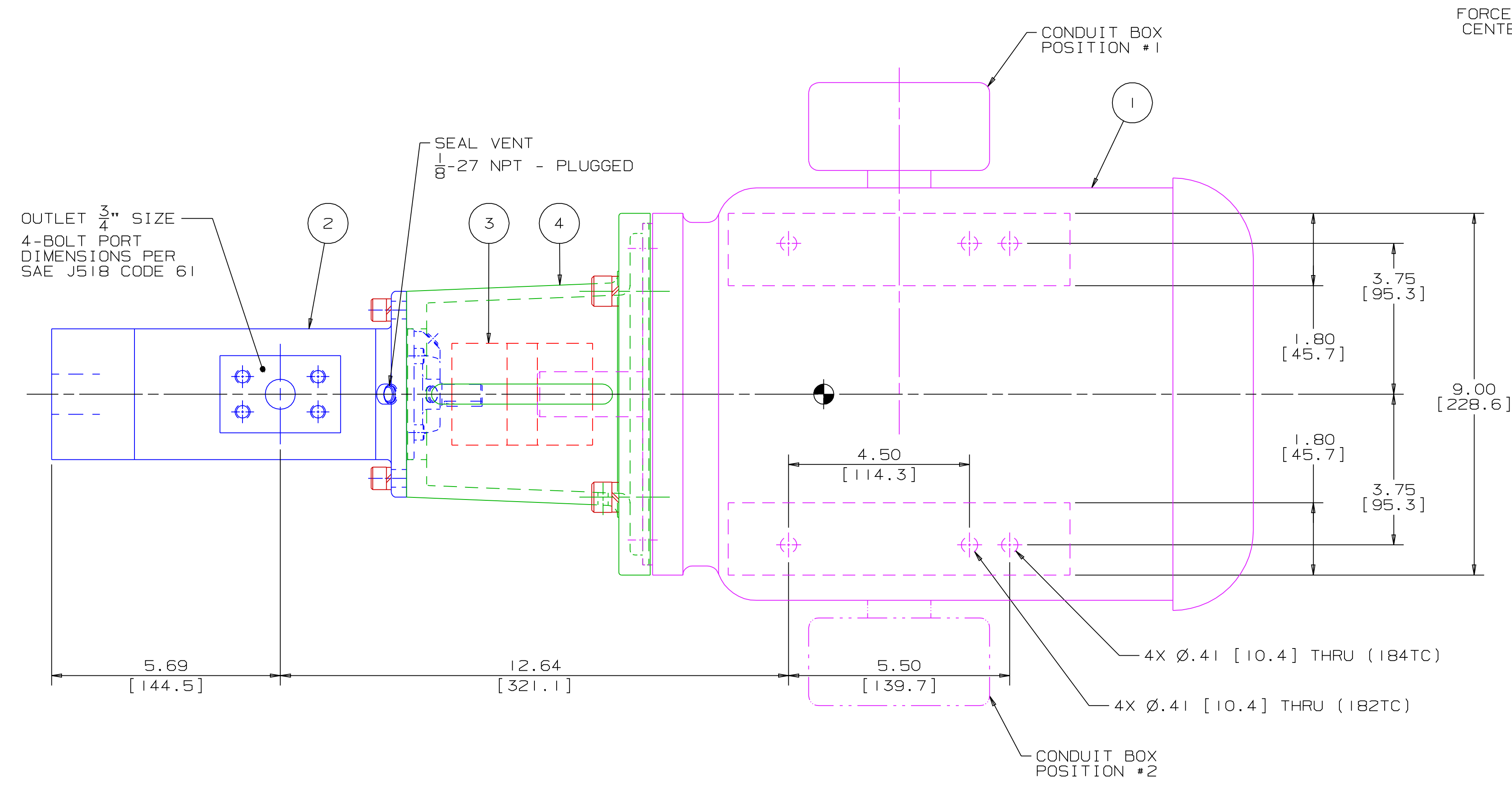

DRAWING CERTIFICATION	
PUMP	<p>12 O'CLOCK 9 O'CLOCK 3 O'CLOCK 6 O'CLOCK **SEE NOTES 4 & 5**</p>
	CUSTOMER NAME -----
	CUSTOMER PO NUMBER ----- CUSTOMER PART NUMBER -----
	UNIT BOM NUMBER -----
MOTOR	PUMP TYPE ----- SHAFT ROTATION ----- INLET PORT ORIENTATION ----- OUTLET PORT ORIENTATION ----- INLET ADAPTER OPTION ----- OUTLET ADAPTER OPTION -----
	MOTOR MANUFACTURER ----- TYPE ----- FRAME ----- POWER ----- ROTATING SPEED ----- PHASE(S) ----- FREQUENCY ----- VOLTAGE ----- CONDUIT BOX POSITION ----- MOTOR INSTALLED BY -----
	CERTIFIED BY -----
	IMO ORDER NUMBER -----
	CERTIFICATION DATE -----
	CERTIFICATION REV. NO. -----
NOTES:	

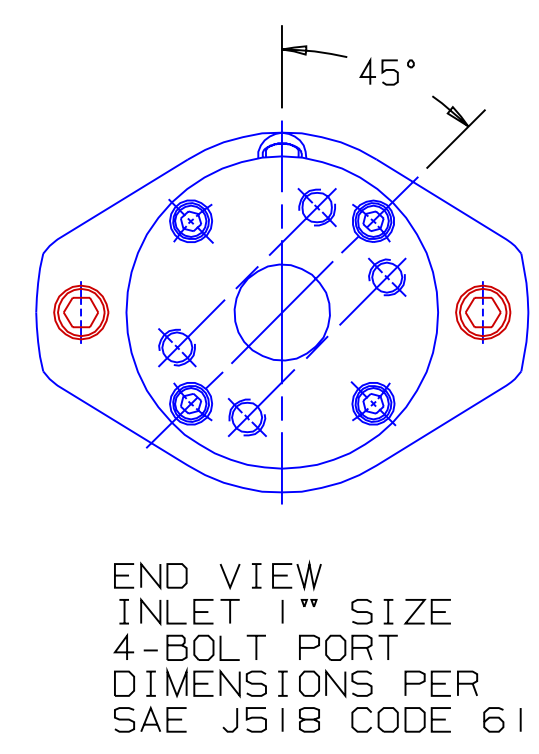
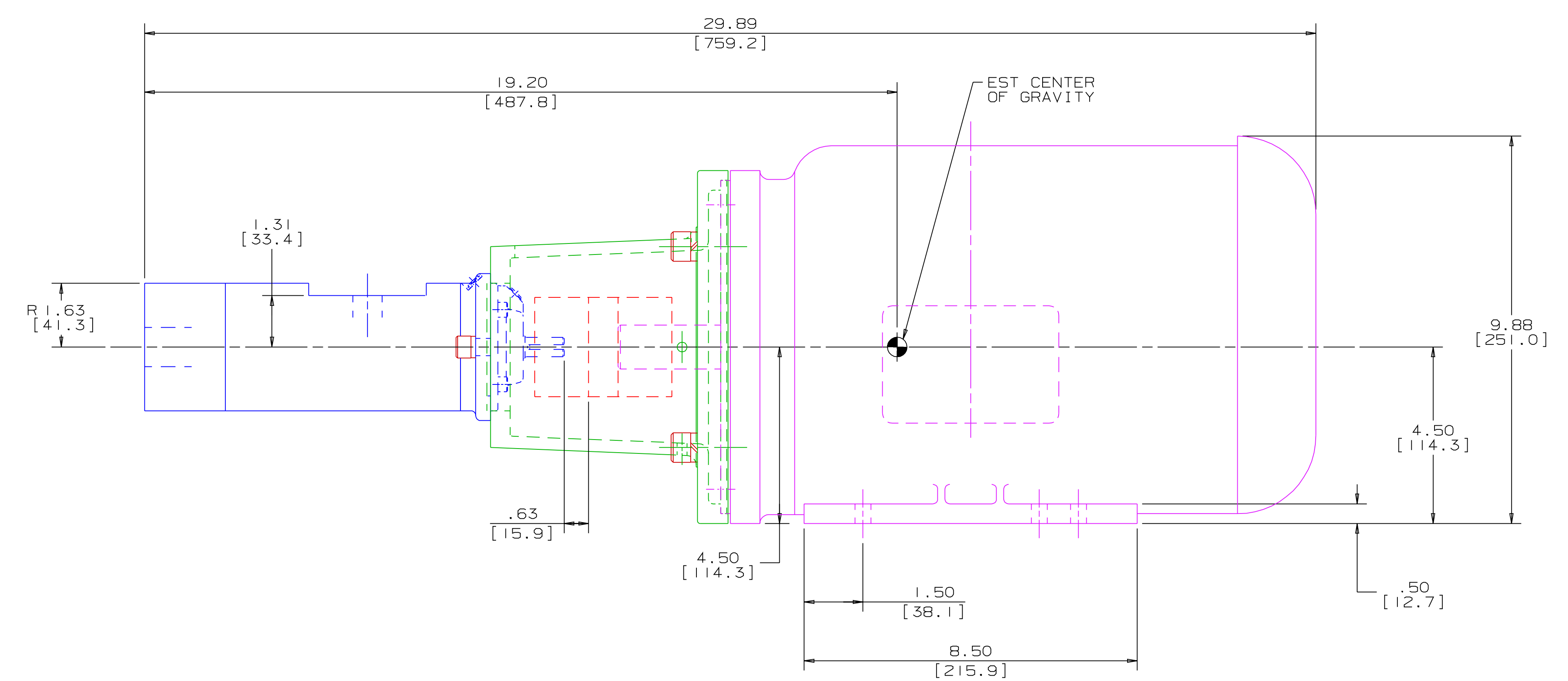

- NOTES:
- UNLESS OTHERWISE SPECIFIED, ALL DIMENSIONS ARE IN INCHES. DIMENSIONS IN [] ARE MILLIMETERS.
 - THIS IS A STANDARD PRE-ENGINEERED UNIT OUTLINE. ANY CHANGES OUTSIDE OF THE CERTIFICATION BLOCK WILL REQUIRE A NEW DRAWING ASSIGNMENT.
 - APPROXIMATE WEIGHT AND ESTIMATED C/G DO NOT INCLUDE OPTIONAL ADAPTERS OR OPTIONAL RELIEF VALVE.
 - TO MAXIMIZE SEAL LIFE, SEAL VENT MUST BE ORIENTED UPWARD (12 O'CLOCK) WHEN PUMP IS INSTALLED HORIZONTALLY. VENT ORIENTATION IS NOT CRITICAL WHEN PUMP IS INSTALLED WITH SHAFT VERTICALLY UPWARD.
 - ALTERNATE PORT ORIENTATIONS ARE PROVIDED IF SPECIFIED ON ORDER. AVAILABLE ORIENTATIONS ARE 3,6,9, AND 12 O'CLOCK.

WEB ADDRESS: WWW.IMO-PUMP.COM		EMAIL: IMO.PUMP@COLFAXCORP.COM	
DRAWN	DMM 10-11-01	<p>IMO Pump 1710 Airport Road PO Box 5020 Monroe, NC USA 28111.5020</p>	TITLE OUTLINE UNIT STANDARD (STEEL) AA3G / S-095
CHECKED	DMM 10-12-01		
APPD	DMM 10-12-01		
PROCESS		SIZE F 59180	DWG NO SDD20275
COMMENTS: STANDARD ROTATION IS CLOCKWISE WHEN VIEWED FROM COUPLING END OF PUMP. SUCTION STRAINER AND DISCHARGE RELIEF VALVE MUST BE PROVIDED. UNITS ARE ACCURATELY ALIGNED AT THE FACTORY. ALIGNMENT SHOULD BE CHECKED BEFORE STARTING TO ENSURE THAT IT IS STILL WITHIN .005 [0.13] FT/M. FLUSH SUCTION PIPING BEFORE CONNECTING PUMP. PRIME AND VENT PUMP. DO NOT START PUMP WITH VALVES CLOSED. READ INSTRUCTION MANUAL FOR DETAILS BEFORE STARTING.		THIRD PARTY EB122A	SCALE 1/2
USED ON STEEL 3G-095 UNIT		WEIGHT SEE ABOVE	SHEET 1 OF 1